

D Submersible pumps for drainage

-  Clear waters
-  Domestic use
-  Civil use



PERFORMANCE RANGE

- Flow rate up to **300 l/min** (18 m³/h)
- Head up to **26 m**

INSTALLATION AND USE

Designed to **drain clear** or slightly dirty water, **D-Series** pumps are ideal for **domestic and civil applications**, including basement and garage flood mitigation, swimming pool and tank drainage, and non-sewage wastewater disposal. Known for their reliability, these pumps excel in automated fixed installations.

INCLUDES

- ※ Power cable length:
 - **5 m** for D8, D10, D20
 - **10 m** for D30
- ※ Float switch (exclusive to single-phase models)

APPLICATION LIMITS

- Depth below water level up to **5 m** (with an appropriately sized power cable)
- Liquid temperature up to **+40 °C**
- Capable of processing suspended solids up to **Ø 10 mm**
- Bottom drainage level up to **17 mm**
- **Minimum immersion for continuous service:**
 - **210 mm for D 8-10-20**
 - **250 mm for D 30**

AVAILABLE UPON REQUEST

- ※ Pumps with **10 m** power cable.
- ※ Different voltage or frequency

PATENTS - TRADE MARKS - MODELS

- Patent No. EP2313658
- Patent No. IT0001428923

CURVES AND PERFORMANCE DATA

60 Hz

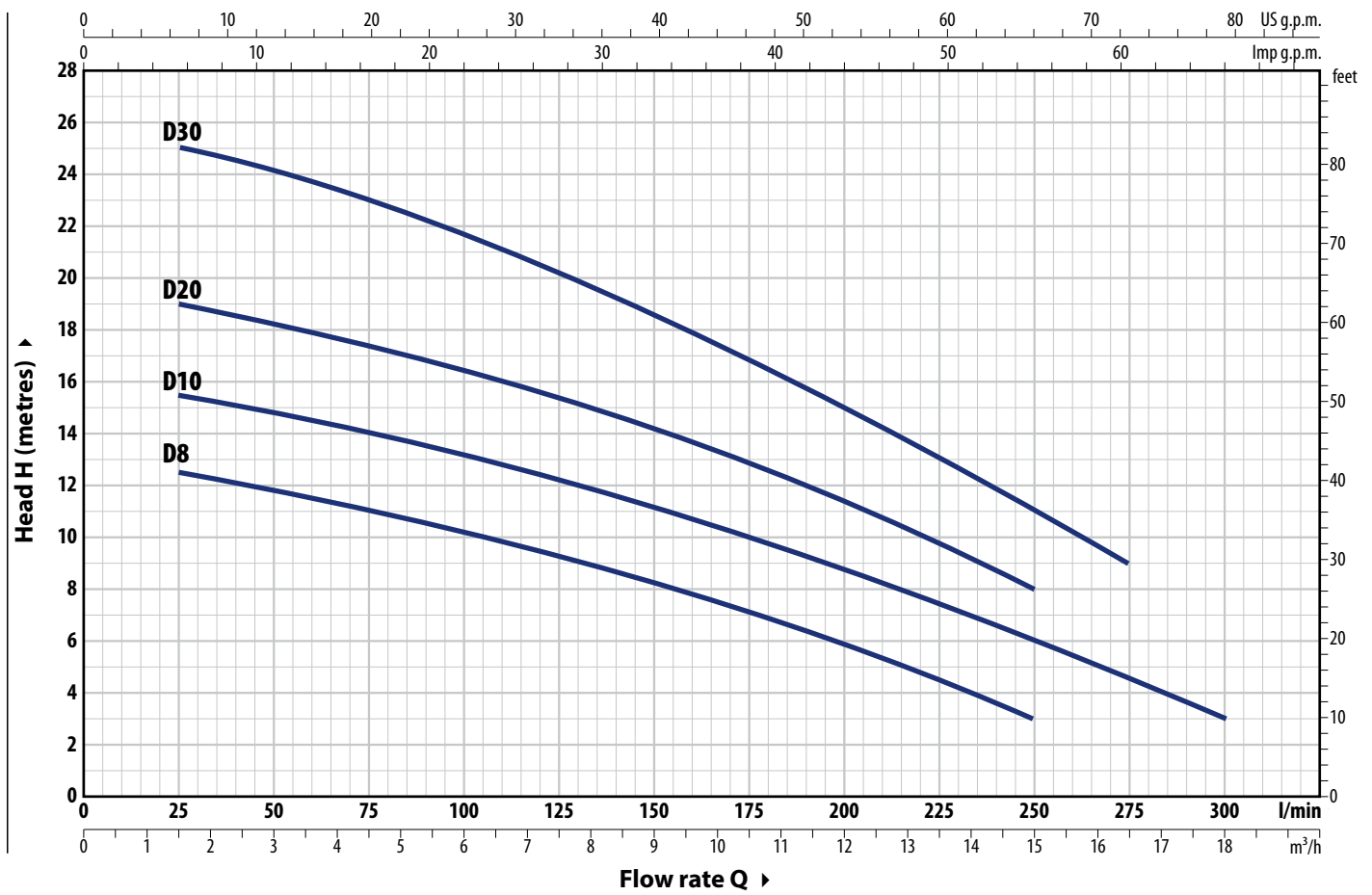

| TYPE | | POWER (P ₂) | | Q | Flow rate | | | | | | | | | | | | | | | | | |
|--------------|-------------|-------------------------|------|------------|-------------------|------|------|------|------|------|------|------|------|------|------|------|------|------|--|--|--|--|
| Single-ph. | Three-ph. | kW | HP | | m ³ /h | 0 | 1.5 | 3.0 | 4.5 | 6.0 | 7.5 | 9.0 | 10.5 | 12.0 | 13.2 | 15.0 | 16.5 | 18.0 | | | | |
| | | | | l/min | 0 | 25 | 50 | 75 | 100 | 125 | 150 | 175 | 200 | 220 | 250 | 275 | 300 | | | | | |
| Dm 8 | D 8 | 0.55 | 0.75 | H m | 13 | 12.5 | 12 | 11 | 10 | 9 | 8 | 7 | 6 | 4.7 | 3 | | | | | | | |
| Dm 10 | D 10 | 0.75 | 1 | | 16 | 15.5 | 15 | 14 | 13.2 | 12.2 | 11.2 | 10 | 8.8 | 7.8 | 6 | 4.5 | 3 | | | | | |
| Dm 20 | D 20 | 0.75 | 1 | | 20 | 19 | 18.5 | 17.5 | 16.5 | 15.5 | 14.3 | 13 | 11.5 | 10 | 8 | | | | | | | |
| Dm 30 | D 30 | 1.1 | 1.5 | | 26 | 25 | 24.4 | 23.2 | 21.8 | 20.3 | 18.7 | 16.9 | 15 | 13.5 | 11.1 | 9 | | | | | | |

Q = Flow rate H = Total manometric head

Performance curves comply with EN ISO 9906 Grade 3B tolerance limits.

ABSORPTION

| TYPE | VOLTAGE | |
|--------------|---------|--------|
| | 220 V | 110 V |
| Dm 8 | 4.0 A | 8.5 A |
| Dm 10 | 5.5 A | 10.0 A |
| Dm 20 | 6.3 A | 13.0 A |
| Dm 30 | 7.7 A | - |

| TYPE | VOLTAGE | |
|-------------|---------|-------|
| | 380 V | 440 V |
| D 8 | 1.8 A | 1.6 A |
| D 10 | 2.3 A | 2.0 A |
| D 20 | 2.8 A | 2.5 A |
| D 30 | 3.3 A | 3.0 A |

DIMENSIONS AND WEIGHT

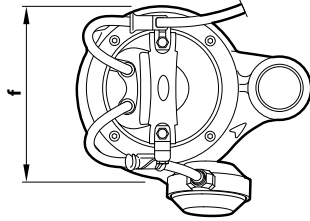
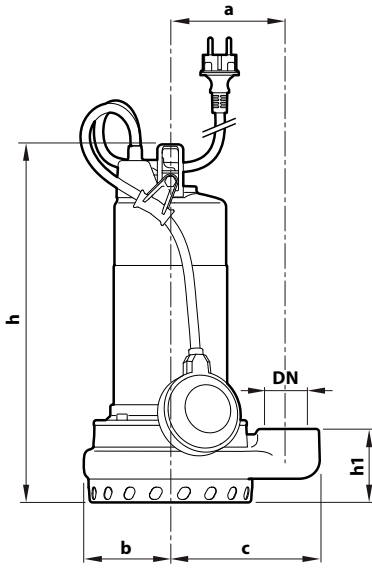

Typical installation

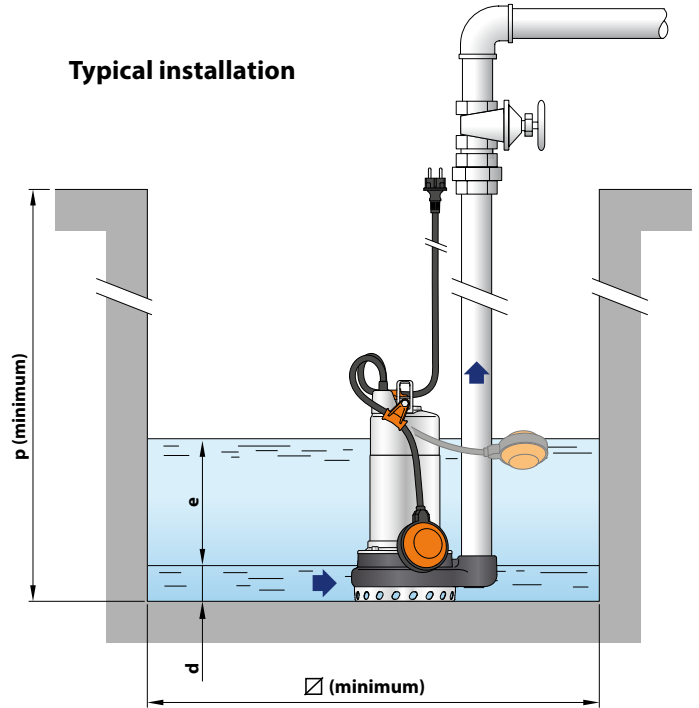

| TYPE | | PORT DN | DIMENSIONS mm | | | | | | | | | | kg | | |
|------------|-----------|------------|---------------|----|-----|-----|-----|-----|----|------------|-----|-----|------|------|------|
| Single-ph. | Three-ph. | | a | b | c | f | h | h1 | d | e | p | ∅ | 1~ | 3~ | |
| Dm 8 | D 8 | 1½" | 115 | 85 | 147 | 177 | 338 | 73 | 17 | adjustable | 500 | 500 | 12.8 | 11.7 | |
| Dm 10 | D 10 | | | | | | 353 | | | | | | 14.0 | 12.9 | |
| Dm 20 | D 20 | | | 93 | | | 195 | 390 | | | | | 84 | 14.0 | 12.9 |
| Dm 30 | D 30 | | | | | | | | | | | | | 17.4 | 16.0 |

PALLET CAPACITY

| TYPE | | GROUPAGE n. pumps | CONTAINER n. pumps |
|------------|-----------|----------------------|-----------------------|
| Single-ph. | Three-ph. | | |
| Dm 8 | D 8 | 60 | 80 |
| Dm 10 | D 10 | 60 | 80 |
| Dm 20 | D 20 | 60 | 80 |
| Dm 30 | D 30 | 60 | 80 |

MATERIALS AND COMPONENTS

| | |
|-------------------------|-------------------------------------------------------------------------------------------------|
| 1 Pump body | Cast iron with cathoporesis treatment, provided with ISO 228/1 threaded port |
| 2 Suction filter | Stainless steel AISI 304 |
| 3 Suction cover | Stainless steel AISI 304 |
| 4 Impeller | Open type in technopolymer |
| 5 Motor sleeve | Stainless steel AISI 304 |
| 6 Motor cover | AISI 304 stainless steel for D 8-10-20 Cast iron with cathoporesis treatment for D 30 |
| 7 Motor shaft | Stainless steel AISI 431 |

8 Double shaft seal with interposed oil chamber

| Water pump | Seal | Shaft | Location | Materials |
|--------------|----------------------------------------|---------------------------------|------------|----------------------|
| D8, D10, D20 | MG1-14D SIC | Ø 14 mm | Motor side | SiC / Graphite / NBR |
| | | | Pump side | SiC / SiC / NBR |
| D30 | ST1-14 SIC Shaft seal | Ø 14 mm Ø 16 x Ø 24 x H 5 mm | | Ceramic / SiC / NBR |

9 Capacitor

(exclusive to single-phase models)

10 Electric motor

Dm: single-phase 220 V - 60 Hz or 110 V - 60 Hz with winding integrated thermal motor protection

D: three-phase 380 V - 60 Hz or 440 V - 60 Hz

- Insulation: class F
- Protection rating: IP X8

11 Power cord

Type 'H07 RN-F
(Schuko plug exclusive to single-phase models)
✳ Standard length 5 metres (10 metres for D30)

12 Float switch (exclusive to single-phase models)

13 Tilting device for the float cable

(exclusive to single-phase models)

Patent No. IT0001428923

14 Power cable strain relief

Patent No. EP2313658

