

 Clean water

 Domestic use

 Civil use

PERFORMANCE RANGE

- Flow rate up to **160 l/min** (9.6 m³/h)
- Head up to **56 m**

INSTALLATION AND USE

Designed to transfer clean water free from abrasive particles and liquids that will not damage the pump's components.

Reliable and easy to operate, these pumps have extensive application in domestic and civil settings, particularly for distributing water with small to medium-sized pressure tanks, transferring fluids, and watering orchards and gardens.

※ **The AISI 304 stainless steel impeller comes with a ten-year guarantee**

APPLICATION LIMITS

- Manometric suction head up to **7 m**
- Liquid temperature between **-10 °C** and **+90 °C**
- Ambient temperature up to **+40 °C**
- Maximum working pressure:
 - **6 bar** for CP 600-610-620
 - **10 bar** for CP 650-660-670

AVAILABLE UPON REQUEST

- ※ Mechanical seal options available
- ※ Protection rating IPX5 for CP 650-660-670
- ※ Different voltage or frequency

PATENTS - TRADE MARKS - MODELS

- CPm158 registered trademark no. 0001516350
- Registered community model no. 002098434

CURVES AND PERFORMANCE DATA – HS=0 m

60 Hz

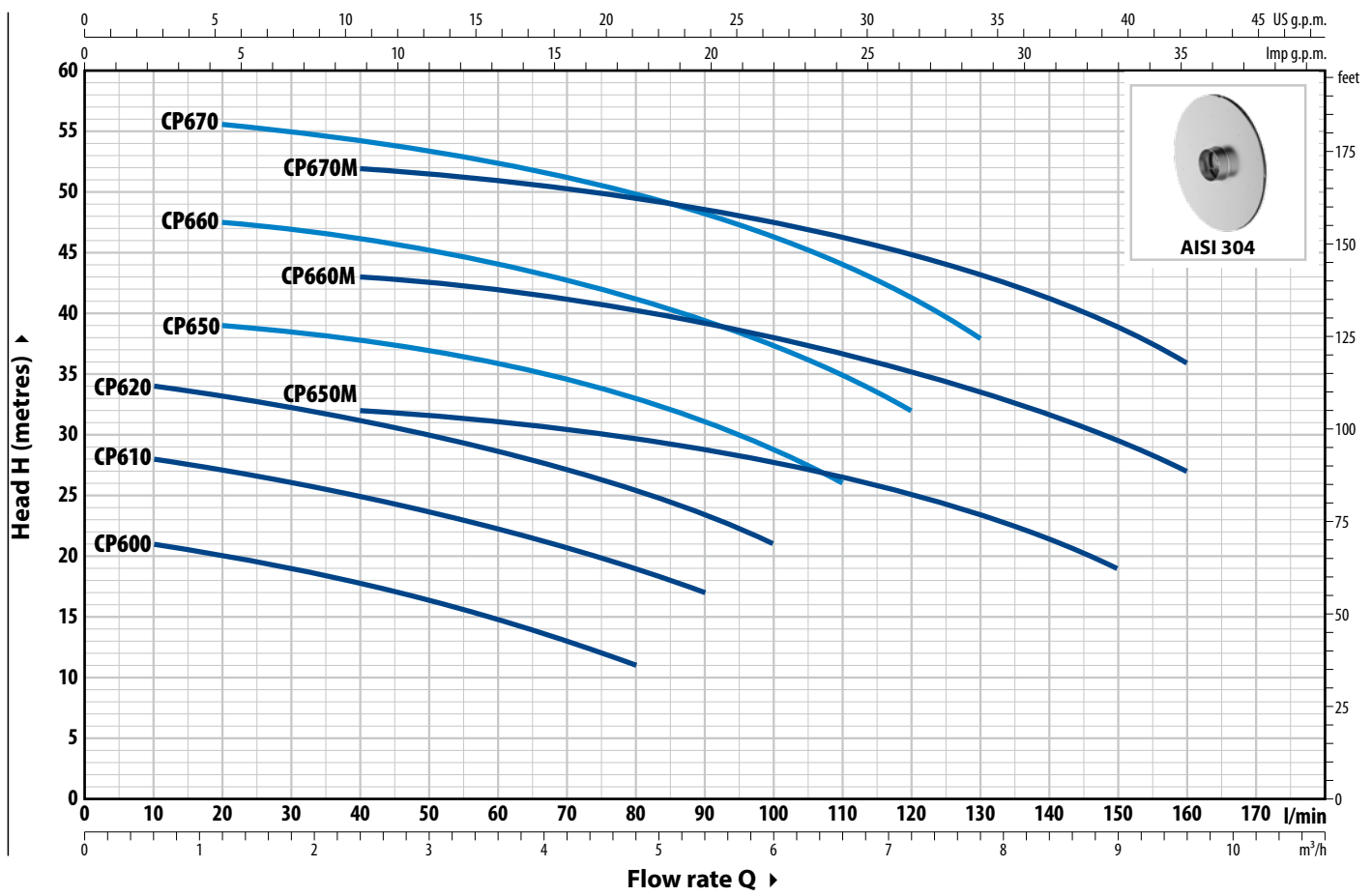

TYPE		POWER (P ₂)		3~	Q	Flow rate															
Single-ph.	Three-ph.	kW	HP			m ³ /h	0	0.6	1.2	2.4	3.6	4.8	5.4	6.0	6.6	7.2	7.8	9.0	9.6		
					l/min	0	10	20	40	60	80	90	100	110	120	130	150	160			
CPm 600	CP 600	0.37	0.50	IE2	H m	22	21	20	18	15	11										
CPm 610	CP 610	0.60	0.85			28.5	28	27	25	22	19	17									
CPm 620	CP 620	0.75	1			35	34	33	31	28.5	25.5	23.5	21								
CPm 650	CP 650	1.1	1.5			40	–	39	38	36	33.1	31.2	28.8	26							
CPm 660	CP 660	1.5	2			48	–	47.5	46	44	41	39.5	37.5	35	32						
CPm 670	CP 670	2.2	3			56	–	55.5	54.5	52.5	50	48.5	46.5	44	41.5	38					
CPm 650M	CP 650M	1.1	1.5			33	–	–	32	31	30	29	28	26.5	25	23	19				
CPm 660M	CP 660M	1.5	2			44	–	–	43	42	40	39	38	37	35.5	34	29.5	27			
CPm 670M	CP 670M	2.2	3	53	–	–	52	51	49.5	48.5	47.5	46.5	45	43.5	39	36					

Q = Flow rate H = Total manometric head HS = Suction height

Performance curves comply with EN ISO 9906 Grade 3B tolerance limits.

ABSORPTION

TYPE	VOLTAGE	
	220 V	110 V
Single-ph.		
CPm 600	2.7 A	5.5 A
CPm 610	4.0 A	8.0 A
CPm 620	6.0 A	12.0 A
CPm 650	8.8 A	-
CPm 650M	8.8 A	-
CPm 660	9.7 A	-
CPm 660M	9.7 A	-
CPm 670	13.2 A	-
CPm 670M	12.0 A	-

TYPE	VOLTAGE			
	220 V - Δ	380 V - Δ	220 V - Δ	440 V - Δ
Three-ph.				
CP 600	1.8 A	1.0 A	2.0 A	1.2 A
CP 610	2.8 A	1.6 A	2.6 A	1.5 A
CP 620	4.2 A	2.4 A	4.2 A	2.4 A
CP 650	7.5 A	4.3 A	5.8 A	3.2 A
CP 650M	7.5 A	4.3 A	5.8 A	3.2 A
CP 660	7.6 A	4.4 A	5.9 A	3.2 A
CP 660M	7.6 A	4.4 A	6.4 A	4.1 A
CP 670	10.4 A	6.0 A	8.8 A	5.0 A
CP 670M	8.6 A	5.0 A	7.8 A	4.5 A

DIMENSIONS AND WEIGHT

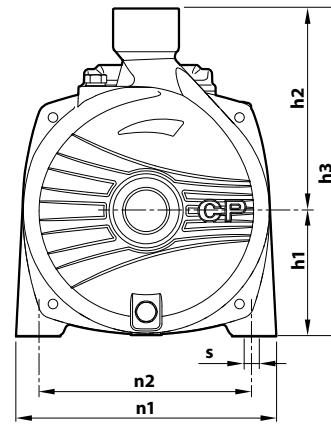
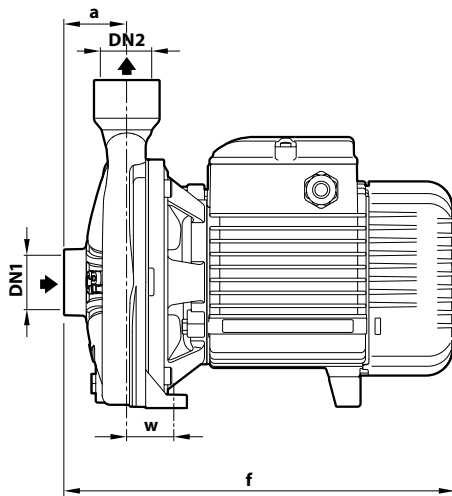

TYPE		PORTS		DIMENSIONS mm									kg	
Single-ph.	Three-ph.	DN1	DN2	a	f	h3	h1	h2	n1	n2	w	s	1~	3~
CPm 600	CP 600	1"	1"	42	257	205	82	123	165	135	38	11	7.0	7.7
CPm 610	CP 610												8.5	7.8
CPm 620	CP 620												10.9	10.9
CPm 650 - 650M	CP 650 - 650M	1 1/4"	1"	51	367	260	110	150	206	165	44.5	11	17.7	17.6
CPm 660 - 660M	CP 660 - 660M												19.0	17.9
CPm 670 - 670M	CP 670 - 670M												20.9	22.5

PALLET CAPACITY

TYPE		GROUPAGE	CONTAINER
Single-phase	Three-phase	n. pumps	n. pumps
CPm 600	CP 600	96	144
CPm 610	CP 610	96	144
CPm 620	CP 620	70	112
CPm 650 - 650M	CP 650 - 650M	50	70
CPm 660 - 660M	CP 660 - 660M	50	70
CPm 670 - 670 M	-	50	70
-	CP 670 - 670 M	35	49

CONSTRUCTION FEATURES

1 Pump body Cast iron with cathaphoresis treatment with ISO 228/1 threaded ports

2 Cover **AISI 304** stainless steel (cast iron for models CP 170-170M-190-200)

3 Impeller Stainless steel **AISI 304**

4 Mechanical seal	Pump	Seal	Shaft	Materials
	CP 600-610	AR-12	Ø 12 mm	Ceramic / Graphite / NBR
	CP 620	AR-14	Ø 14 mm	Ceramic / Graphite / NBR
	CP 650-660-670	FN-18	Ø 18 mm	Graphite / Ceramic / NBR
	CP 650M-660M-670M			

5 Motor shaft Stainless steel **AISI 431**

6 Electric motor **CPm**: single-phase 220 V - 60 Hz with winding integrated thermal motor protection.
CP: three-phase 220/380 V - 60 Hz or 220/440 V - 60 Hz

- The three-phase pumps are fitted with high performance motors up to P2=0.60 kW in class **IE2** and from P2=0.75 kW in class **IE3** (IEC 60034-30-1)
- Continuous running duty **S1**
- Insulation: class F
- Protection rating: IPX5

